

DOWELS REQUIRED  
IN CENTER ONLY  
WHEN NOT POURED  
CONTINUOUSLY.

3/4" SMOOTH DOWELS  
18" LONG - GREASE ONE END

TRANSVERSE DUMMY  
JOINT ON CENTER LINE  
(SEE SECTION B-B)

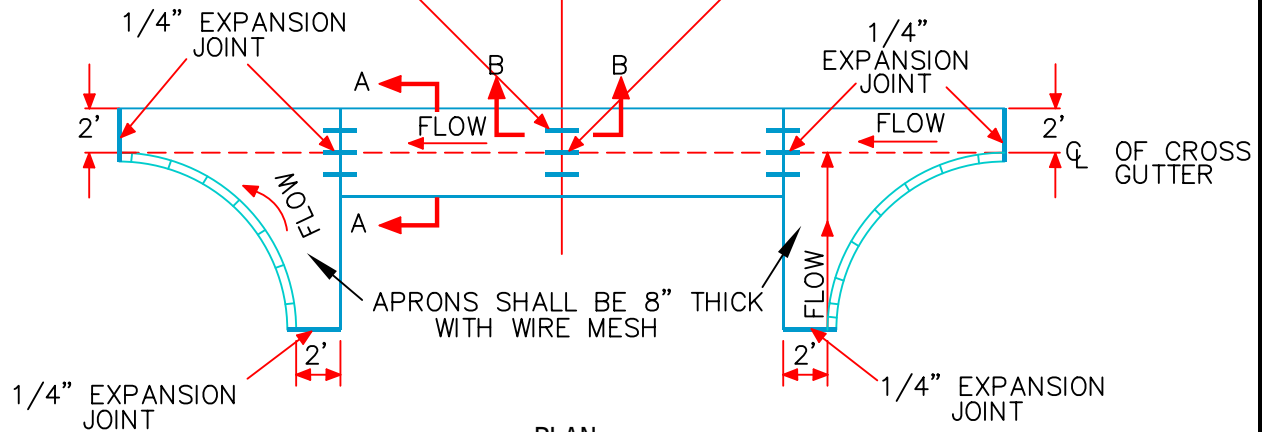

PLAN

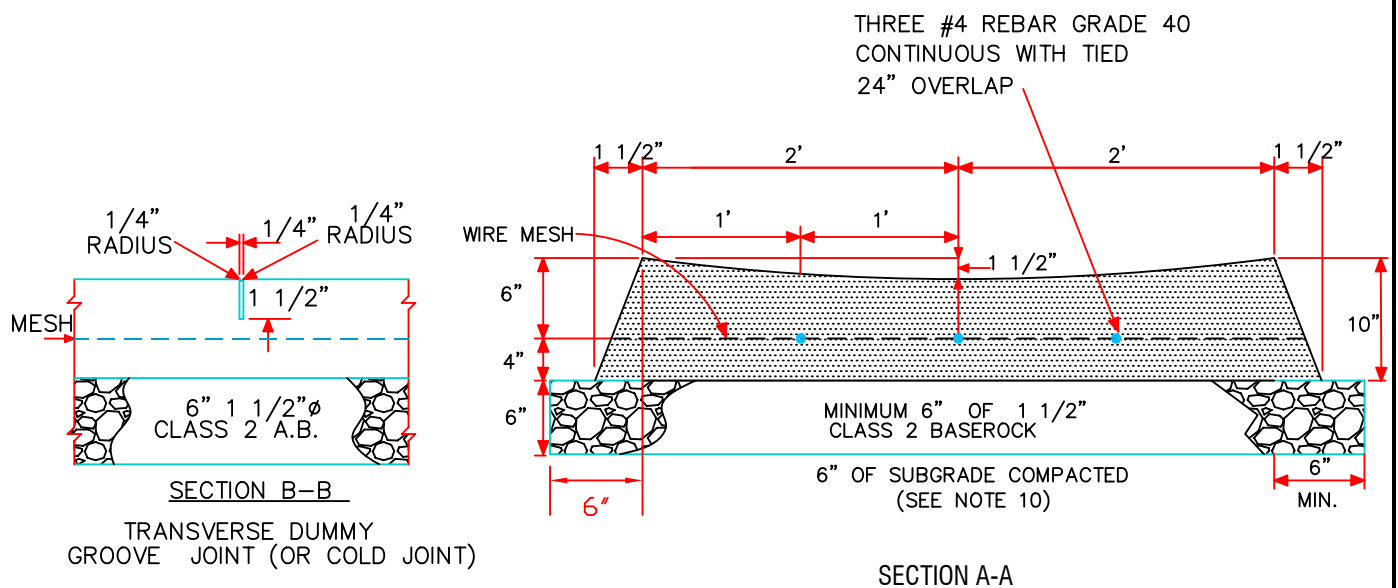

SECTION A-A

NOTES:

- UNLESS OTHERWISE SPECIFIED, CROSS GUTTER CONSTRUCTION SHALL ADHERE TO REQUIREMENTS OF SECTION 73 OF THE STANDARD SPECIFICATIONS, CALIFORNIA DEPARTMENT OF TRANSPORTATION.
- PAVEMENT SLOPES OF LESS THAN 2% SHALL REQUIRE A CONCRETE VALLEY GUTTER IN PUBLIC AND PRIVATE AREAS.
- WIRE MESH SHALL BE 6"X6" SQUARES NO. 10 X NO. 10 ELECTRICALLY WELDED WIRE PER A.S.T.M. DESIGNATION A185-53-T
- THREE #4 REBARS GRADE 40-CONTINUOUS WITH TIED 24" OVERLAP
- WEAKENED PLANE JOINTS SHALL BE CONSTRUCTED AT 20' INTERVALS AT RIGHT ANGLES TO THE FLOWLINE.
- DOWELS REQUIRED ONLY WHEN GUTTER IS POURED IN PHASES. DOWELS ARE 3/4" SMOOTH, 18" LONG. GREASE ONE END.
- GUTTER SHALL BE POURED MONOLITHICALLY UNLESS OTHERWISE APPROVED BY CITY INSPECTOR.
- IF DIRECTIONAL FLOW OF CROSS GUTTER IS OPPOSITE TO THAT SHOWN, THE DETAIL OF FLOW AT EACH CURB WILL BE THAT OF THE OPPOSITE RETURN ON THE LINE OF THE CROSS GUTTER.
- CONCRETE SHALL BE 3,000 psi COMPRESSIVE STRENGTH IN 28-DAYS (MINIMUM) OR MEET REQUIREMENTS OF SECTION 90-10 OF THE STANDARD SPECIFICATIONS, CALIFORNIA DEPARTMENT OF TRANSPORTATION, WHICHEVER IS MORE STRINGENT.
- BASEROCK TO BE CLASS 2, 1 1/2", COMPACTED TO 95% RELATIVE COMPACTION AT OPTIMUM MOISTURE CONTENT.
- NATIVE SUBGRADE TO BE COMPACTED TO 90% RELATIVE COMPACTION AT OPTIMUM MOISTURE CONTENT.



PUBLIC WORKS DEPARTMENT

Drawing File No. S-106

APPROVED: \_\_\_\_\_

TIMOTHY P. O'HALLORAN, CITY ENGINEER - RCE NO. 49501

STANDARD DRAWING FOR  
CONCRETE CROSS  
GUTTER

CITY COUNCIL RESOLUTION NO: